

Metric Rod Connectors DIN6334 (EN4032) A2

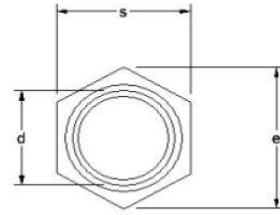
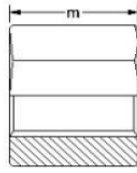

Length/dim	M5	M6	M8	M10	M12	M14	M16	M20	M24	M30
e	9	11.1	15	19.6	21.9	25.5	27.7	34.6	41.6	53.1
m	15	18	24	30	36	42	48	60	72	90
Pitch	0.8	1	1.25	1.5	1.75	2	2	2.5	3	3.5
s	8	10	13	17	19	22	24	30	36	46
Length/dim	M5	M6	M8	M10	M12	M14	M16	M20	M24	M30
	x	x	x	✓	✓	✓	✓	✓	x	x

✓ = Indicates sizes normally available from stock or on short lead time.
 x = Indicates sizes available to order (subject to minimum order quantity)